





ALMA

The surface finishing

**PRODOTTI DI CONSUMO
CONSUMABLES**

 ALMA con i suoi prodotti di consumo per vibrofinitura copre l'intera gamma di specialità: inserti, paste, composti chimici, adatti per tutti i metalli (acciaio inox, alluminio, ferro, ottone, zama).

 ALMA with its consumable products for vibrofinishing covers the whole range of specialties: media, polishing paste, chemical compounds, suitable for all metals (stainless steel, aluminum, iron, brass, zinc alloy).

Gli inserti per vibrofinitura si differenziano per tipo di formulazione/miscela e forma, che ne determinano la specifica funzione in base al trattamento di finitura da eseguire.

The media for vibrofinishing vary depending on the type of formulation / mixture and form, which determine the specific function according to the finishing treatment to be performed.

Tali inserti possono essere:

These media can be:

- **Abrasivi:** sgrossatura, sbavatura e levigatura
- **Ausiliari:** lucidatura ad umido, brillantatura
- **Vegetali:** asciugatura, lucidatura a secco

- **Abrasive:** grinding, deburring and smoothing
- **Auxiliary:** wet polishing, burnishing
- **Vegetable:** dry polishing, drying

Le paste di vibrofinitura svolgono la loro funzione utilizzando come "supporto" l'inerzia dell'inserto in movimento all'interno della macchina. In base ai differenti leganti organici ed agli abrasivi contenuti nella miscela ogni singolo tipo di pasta di vibrofinitura svolge un'azione specifica.

The vibrofinishing pastes perform its function using as a "drive" the inertia of the media moving inside the machine. Based on the different organic binders and abrasives contained in the mixture, each individual type of vibrofinishing paste performs a specific action.

I composti chimici proposti da ALMA si orientano al settore della vibrofinitura (come additivi per le fasi di sbavatura, levigatura, lucidatura e brillantatura), al trattamento diretto sul metallo sia di tipo conservativo (detergenti, protettivi) che di attacco (decapanti, disossidanti, anneritori, bronzanti).

The chemical compounds provided by ALMA are designed for the vibrofinishing industry (as additives for deburring, smoothing, polishing and burnishing), as direct treatment on the metal with action both conservative (detergents, protective) and aggressive (pickling, descaling, blackening, bronzing).





ABRASIVI A LEGANTE UREICO UREA MEDIA



Conico Cone

| Tipo Type | mm | |
|--------------|----|----|
| | A | B |
| C 15 | 14 | 20 |
| C 23* | 23 | 25 |
| C 30 | 30 | 35 |
| C 35* | 35 | 38 |
| C 40 | 40 | 50 |
| C 60 | 56 | 67 |

| qualità quality | potere di taglio grinding performance |
|--------------------|--|
| UG | ■ ■ ■ ■ ■ ■ ■ ■ |
| UR | ■ ■ ■ ■ ■ ■ ■ ■ |

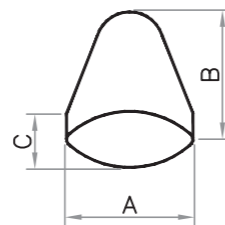
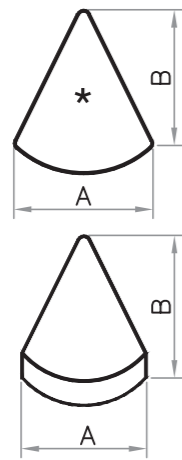

Paraboloide Paraboloid

| Tipo Type | mm | | |
|--------------|----|----|----|
| | A | B | C |
| G 50 | 46 | 50 | 27 |
| G 70 | 70 | 72 | 40 |

| qualità quality | potere di taglio grinding performance |
|--------------------|--|
| UG | ■ ■ ■ ■ ■ ■ ■ ■ |
| UR | ■ ■ ■ ■ ■ ■ ■ ■ |

Piramidale Pyramid

| Tipo Type | mm | | |
|--------------|----|----|----|
| | A | B | C |
| P 20 | 18 | 18 | 17 |
| P 30 | 30 | 30 | 30 |

| qualità quality | potere di taglio grinding performance |
|--------------------|--|
| UR | ■ ■ ■ ■ ■ ■ ■ ■ |

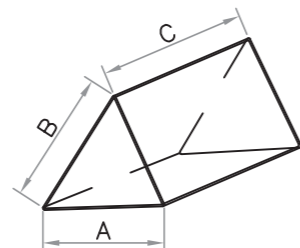
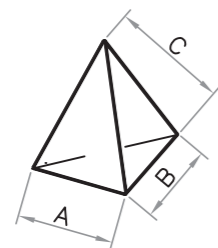

Triangolare Triangle

| Tipo Type | mm | | |
|--------------|----|----|----|
| | A | B | C |
| T 15 | 15 | 15 | 12 |
| T 19 | 26 | 19 | 18 |

| qualità quality | potere di taglio grinding performance |
|--------------------|--|
| UR | ■ ■ ■ ■ ■ ■ ■ ■ |

ABRASIVI A LEGANTE POLIESTERE POLYESTER MEDIA



Conico Cone

| Tipo Type | mm | |
|--------------|----|----|
| | A | B |
| C 10 | 10 | 10 |
| C 12 | 12 | 14 |
| C 14 | 14 | 14 |
| C 20 | 20 | 21 |
| C 25 | 25 | 27 |
| C 30 | 28 | 31 |
| C 40 | 42 | 45 |
| C 60 | 59 | 57 |

| qualità quality | potere di taglio grinding performance |
|--------------------|--|
| OB | ■ ■ ■ ■ ■ ■ ■ ■ |
| OM | ■ ■ ■ ■ ■ ■ ■ ■ |
| PG | ■ ■ ■ ■ ■ ■ ■ ■ |

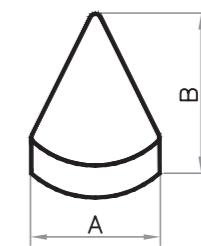



ABRASIVI CERAMICI CERAMIC MEDIA

Cilindrico Cylinder

| Tipo Type | mm | |
|------------------|----|----|
| | A | B |
| CIL 4x8 | 4 | 8 |
| CIL 7x10 | 7 | 10 |
| CIL 15x20 | 15 | 20 |

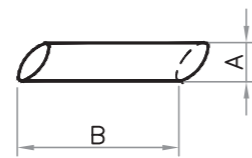
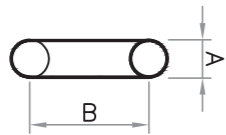

Cilindrico obliquo Angle cut cylinder

| Tipo Type | mm | |
|-----------------|----|----|
| | A | B |
| FS 4x8 | 4 | 8 |
| FS 7x15 | 7 | 15 |
| FS 10x20 | 10 | 20 |
| FS 15x30 | 15 | 30 |

| qualità quality | potere di taglio grinding performance | | | | | | | | | |
|--------------------|--|----|---|---|---|---|---|---|---|---|
| | N | SA | A | S | | | | | | |
| N | ■ | □ | □ | □ | □ | □ | □ | □ | □ | □ |
| SA | ■ | ■ | □ | □ | □ | □ | □ | □ | □ | □ |
| A | ■ | ■ | ■ | □ | □ | □ | □ | □ | □ | □ |
| S | ■ | ■ | ■ | ■ | □ | □ | □ | □ | □ | □ |

Conico Cone

| Tipo Type | mm | |
|--------------|----|----|
| | A | B |
| C 15 | 15 | 15 |
| C 30 | 30 | 30 |

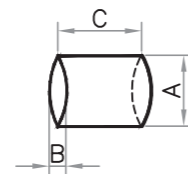
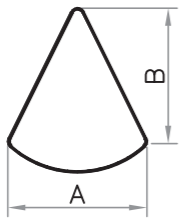

Ellittico Ellipse

| Tipo Type | mm | | |
|------------------|----|----|----|
| | A | B | C |
| ELL 10x5 | 10 | 5 | 15 |
| ELL 15x7 | 15 | 7 | 15 |
| ELL 25x10 | 25 | 10 | 25 |

| qualità quality | potere di taglio grinding performance | | | | | | | | | |
|--------------------|--|----|---|---|---|---|---|---|---|---|
| | N | SA | A | S | | | | | | |
| N | ■ | □ | □ | □ | □ | □ | □ | □ | □ | □ |
| SA | ■ | ■ | □ | □ | □ | □ | □ | □ | □ | □ |
| A | ■ | ■ | ■ | □ | □ | □ | □ | □ | □ | □ |
| S | ■ | ■ | ■ | ■ | □ | □ | □ | □ | □ | □ |



ABRASIVI CERAMICI CERAMIC MEDIA

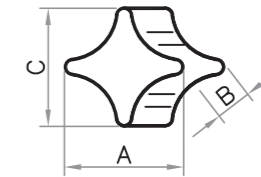

Stellare Star

| Tipo Type | mm | | |
|-----------------|----|----|----|
| | A | B | C |
| S4 10x6 | 10 | 6 | 10 |
| S4 20x10 | 20 | 10 | 20 |
| S4 30x10 | 30 | 10 | 30 |

| qualità quality | potere di taglio grinding performance | | | | | | | | | |
|--------------------|--|----|---|---|---|---|---|---|---|---|
| | N | SA | A | S | | | | | | |
| N | ■ | □ | □ | □ | □ | □ | □ | □ | □ | □ |
| SA | ■ | ■ | □ | □ | □ | □ | □ | □ | □ | □ |
| A | ■ | ■ | ■ | □ | □ | □ | □ | □ | □ | □ |
| S | ■ | ■ | ■ | ■ | □ | □ | □ | □ | □ | □ |

Triangolare Triangle

| Tipo Type | mm | | |
|--------------|----|----|----|
| | A | B | C |
| T 4 | 4 | 4 | 4 |
| T 6 | 6 | 6 | 6 |
| T 10 | 10 | 10 | 10 |
| T 12 | 12 | 12 | 12 |
| T 15 | 15 | 15 | 15 |
| T 20 | 20 | 20 | 20 |
| T 25 | 25 | 25 | 25 |
| T 30 | 30 | 30 | 30 |
| T 40 | 40 | 40 | 40 |
| T 50 | 50 | 50 | 50 |

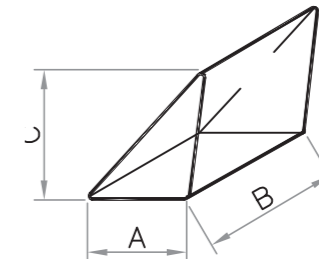
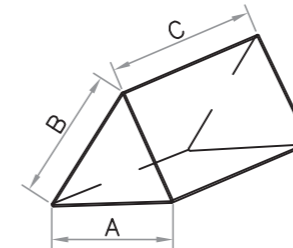

Triangolare obliquo Angle cut triangle

| Tipo Type | mm | | |
|-----------------|----|----|----|
| | A | B | C |
| TO 3x6 | 3 | 6 | 3 |
| TO 6x15 | 6 | 15 | 6 |
| TO 10x15 | 10 | 15 | 10 |
| TO 15x15 | 15 | 30 | 15 |
| TO 20x20 | 20 | 30 | 20 |
| TO 25x25 | 25 | 30 | 25 |
| TO 30x30 | 30 | 30 | 30 |

| qualità quality | potere di taglio grinding performance | | | | | | | | | |
|--------------------|--|----|---|---|---|---|---|---|---|---|
| | N | SA | A | S | | | | | | |
| N | ■ | □ | □ | □ | □ | □ | □ | □ | □ | □ |
| SA | ■ | ■ | □ | □ | □ | □ | □ | □ | □ | □ |
| A | ■ | ■ | ■ | □ | □ | □ | □ | □ | □ | □ |
| S | ■ | ■ | ■ | ■ | □ | □ | □ | □ | □ | □ |

INSERTI IN PORCELLANA PORCELAIN MEDIA



Cilindrico obliquo Angle cut cylinder

| Tipo Type | mm | |
|--------------|----|----|
| | A | B |
| FS 3x3 KE | 3 | 3 |
| FS 3x6 KE | 3 | 6 |
| FS 3x10 KE | 3 | 10 |
| FS 3x15 KE | 3 | 15 |
| FS 4x4 KE | 4 | 4 |
| FS 4x6 KE | 4 | 6 |
| FS 4x10 KE | 4 | 10 |
| FS 4x15 KE | 4 | 15 |
| FS 5x5 KE | 5 | 5 |
| FS 5x10 KE | 5 | 10 |
| FS 5x15 KE | 5 | 15 |
| FS 5x20 KE | 5 | 20 |
| FS 6x6 KE | 6 | 6 |
| FS 6x10 KE | 6 | 10 |
| FS 6x15 KE | 6 | 15 |
| FS 6x20 KE | 6 | 20 |

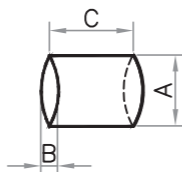
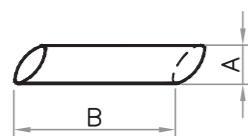

Ellisse Ellipse

| Tipo Type | mm | | |
|-----------------|----|----|----|
| | A | B | C |
| ELL 10x5x10 KE | 10 | 5 | 10 |
| ELL 10x5x12 KE | 10 | 5 | 12 |
| ELL 10x5x15 KE | 10 | 5 | 15 |
| ELL 15x7x15 KE | 15 | 7 | 15 |
| ELL 25x10x25 KE | 25 | 10 | 25 |

Sfera Balls

| Tipo Type | mm | |
|--------------|------|------|
| | A | C |
| 0,75-1,5 | 0,75 | 1,50 |
| 1,5-2,5 | 1,50 | 2,50 |
| 2,5-3,5 | 2,50 | 3,50 |
| 3,5-4,5 | 3,50 | 4,50 |
| 4,0-6,0 | 4,00 | 6,00 |

INSERTI ALTA DENSITÀ HIGH DENSITY MEDIA



Forme varie Various shapes

| Tipo Type | Forma Shape | |
|------------------|----------------|----------|
| FM 9 3x5 SCT | Triangolo | Triangle |
| FM 9 3x6 ACC | Cilindro | Cylinder |
| FM 9 4x12 ACC | Cilindro | Cylinder |
| FM 9 6x13 ACC | Cilindro | Cylinder |
| FM 9 8x13 ACC | Cilindro | Cylinder |
| FM 9 6x6 ACS | Stella | Star |
| FM 9 6x10 ACS | Stella | Star |
| FM 9 10x10 ACS | Stella | Star |
| FM 9 10x10 ACT | Triangolo | Triangle |
| FM 9 15x15 ACS | Stella | Star |
| FM 9 15x15 ACT | Triangolo | Triangle |
| FM 9 14x5x14 ACE | Ellisse | Ellipse |
| FM 9 15x6x20 ACE | Ellisse | Ellipse |
| FM 9 50x15 ACT | Triangolo | Triangle |



INSERTI INOX INOX MEDIA



Sfere AISI 420 Balls AISI 420

| Tipo Type | Ø mm |
|--------------|------|
| 1/16 | 1,59 |
| 3/32 | 2,38 |
| 7/64 | 2,78 |
| 1/8 | 3,18 |
| 5/32 | 3,97 |
| 3/16 | 4,76 |
| 7/32 | 5,56 |

Satelliti AISI 420 Satellite AISI 420

| Tipo Type | Ø mm | |
|--------------|------|-----|
| | Min | Max |
| 3x5 | 3 | 5 |
| 5x7 | 5 | 7 |



TUTOLO DI MAIS CORN COB MEDIA



Tutolo di mais Corn cob media

| Tipo Type | mm | |
|--------------|-----|-----|
| | A | B |
| GM 08 | 2,5 | 3,5 |
| GM 12 | 1,6 | 2,5 |
| GM 16 | 1,0 | 2,0 |
| GM 20 | 0,8 | 1,5 |
| GM 30 | 0,6 | 1,0 |

GUSCI DI NOCE WALNUT SHELL MEDIA



Gusci di noce Walnut shell media

| Tipo Type | mm | |
|--------------|------|------|
| | A | B |
| GN 08 | 2,7 | 4,0 |
| GN 12 | 1,4 | 1,7 |
| GN 16 | 1,0 | 1,7 |
| GN 20 | 0,45 | 1,0 |
| GN 30 | 0,45 | 0,75 |



LEGNETTI WOODEN MEDIA



Legnetti Wooden media

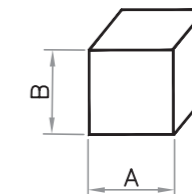

| Tipo Type | mm | |
|--------------|----|----|
| | A | B |
| 4x4 | 4 | 4 |
| 5x10 | 5 | 10 |
| 7x7 | 7 | 7 |
| 7x12 | 7 | 12 |
| 10x10 | 10 | 10 |
| 12x12 | 12 | 12 |



PASTE ABRASIVE ABRASIVE PASTES

| Uso Use | FBP 062 | FBP 071 | FBP 091 | FBP 237 |
|-----------------------------|---------|---------|---------|---------|
| Sgrossatura <i>Grinding</i> | • | | | |
| Levigatura <i>Smoothing</i> | | • | • | • |
| Metalli / Metals | | | | |
| Alluminio <i>Aluminium</i> | | • | | • |
| Ferro <i>Steel</i> | • | • | • | • |
| Inox <i>Stainless Steel</i> | • | • | • | • |
| Ottone <i>Brass</i> | | • | | • |
| Zama <i>Zamak</i> | | • | | • |

PASTE LUCIDANTI POLISHING PASTES

| Uso Use | AK 300 | FBP 051 | M 66 |
|--|--------|---------|------|
| Lucidatura <i>Polishing</i> | | • | |
| Lucidatura a secco <i>Dry polishing</i> | • | | • |
| Materiali / Materials | | | |
| Acetato <i>Acetate</i> | • | | |
| Alluminio <i>Aluminium</i> | | | • |
| Ferro <i>Steel</i> | | | • |
| Inox <i>Stainless Steel</i> | | | • |
| Nylon | • | | |
| Ottone <i>Brass</i> | | • | • |
| Plexiglass | • | | |
| Propionato <i>Propionate</i> | • | | |
| Zama <i>Zamak</i> | | • | • |

COMPOSTI CHIMICI CHEMICAL COMPOUNDS

 Alma propone specialità ad ampio spettro di applicazione/tipologia di metallo e formulazione studiate sull'esigenza del cliente.

Additivi per vibrofinitura

Rientrano in questo campo di applicazioni i composti (liquidi ed in polvere) che svolgono un'azione diversa in base al ciclo richiesto:

- Additivi coadiuvanti l'azione meccanica dell'insero (sbavanti, sfumanti, leviganti - in genere sotto forma di polveri)
- Additivi che esercitano un'azione chimica sul metallo, di attacco (disossidanti, disincrostanti, decapanti) o di mantenimento (protettivi)
- Additivi che esaltano l'estetica del manufatto (brillantanti, lucidanti, sgrassanti)

Additivi per trattamento diretto

- Additivi per anneritura, brunitura diretta
- Additivi per decapaggio
- Additivi per passivazione, protezione
- Additivi per sgrassaggio (chimica a caldo, con sistema ad ultrasuoni)

 Alma offers a wide range of specialties focused on the customer requests.

Additives for vibrofinishing

They are compounds (liquid and powder) which perform a different action depending on the required cycle:

- Additives for mechanical action (deburring, smoothing - usually powder compounds)
- Additives for chemical action (deoxidizing, descaling, pickling) or protection
- Additives that enhance the appearance of surface (brightening, polishing, degreasing)

Additives for direct treatment

- Additives for blackening, bronzing
- Additives for pickling
- Additives for passivation, protection
- Additives for degreasing (soak cleaning and with the ultrasonic system)



ALMA S.r.l. via Virgilio, 9 - Italy - 20833 Giusano (MB)
ph: +39 0362 860171 fax: +39 0362 861280
info@almagiussano.it - www.almagiussano.it



ALMA S.r.l. via Virgilio, 9 - Italy - 20833 Giussano (MB)
ph: +39 0362 860171 fax: +39 0362 861280
info@almagiussano.it - www.almagiussano.it